











**SAFETY GEAR**

- **Primary and secondary anchors**
- **6 x Mooring / dock lines**
- **6 x Fenders**
- **Bell**
- **Anchor bridle, shackles and hook**
- **Flare kit**
- **Life jackets and safety harnesses per max pax**
- **Binoculars**
- **Navigation tools: Parallel rule, compass, dividers**

**GENERAL EQUIPMENT**

- Owner's Operating Manual
- 6 x Fire extinguishers
- Automatic extinguishing system for engine rooms
- NMMA Certification
- CE Certification

**CRUISING GEAR**

- **Fitted cushions forward and aft cockpit**
- **Bed linens per max pax**
- **Plates, cups, saucers, glasses per max pax**
- **Flatware per max pax**
- **Pots, pans, miscellaneous food prep tools**
- **Cooking and serving utensils**
- **Coffee pot, tea kettle, toaster**
- **Towels and washcloths per max pax**
- **Snorkeling gear per max pax**

**GENERAL SPECIFICATIONS**

Length Overall: 15.40m/50ft 6in  
Waterline Length: 14.90m/48ft 11in  
Mast Height: 23.52m/77ft 2in  
Beam: 8.04m/26ft 5in  
Draft: 1.60m/5ft 3in  
Displacement: 20600kg/45415lb  
Fuel Capacity: 920L/243gal  
Water Capacity: 700L/185gal  
Sail Area: 154sqm/1660sqft  
Engines: 2 x 57HP

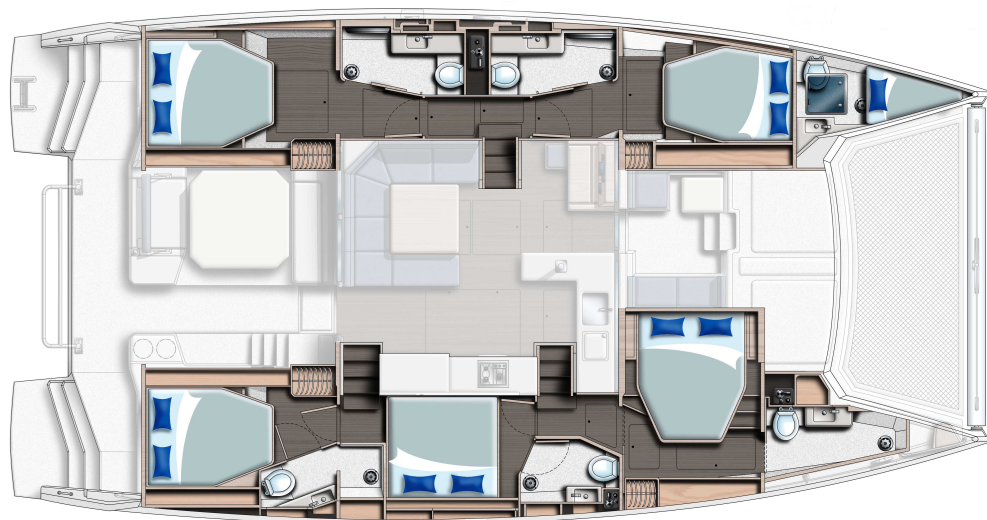

*The Builder reserves the right to change or amend the contents of this document at any time without prior notification to any third party, and no liability will be accepted for errors contained within the same.*

*Initials*

*Initials*